



# Road Dedications

## Relevant Road Sections

**Legend**

- Requested widening to roads managed by MRWA
- Requested widening to roads managed by LG





mainroads  
WESTERN AUSTRALIA

Enquiries: Alf Parolo on 9323 4636  
Our Ref: 09/547  
Your Ref:

28 November 2017

Chief Executive Officer  
City of Karratha  
Lot 1083 Welcome Road  
PO Box 219  
KARRATHA WA 6714

CITY OF KARRATHA  
RECEIVED

- 5 DEC 2017

Action By: Susan Baboo  
File No: ROA 486  
Document ID: ICR 74638  
CC: Pascal Heeking

Dear Name/Sir/Madam

**DEDICATION OF LAND FOR INCLUSION TO: DAMPIER HIGHWAY, DE WITT ROAD & BURRUP ROAD INTERSECTION IN THE CITY OF KARRATHA**

As a part of the Dampier Highway project parcels of Crown land shown on Deposited Plans 405191, 406848 and Land Dealing Plan 1060-086-1 are being dedicated as road for inclusion in the abutting road reserves.

It is a requirement of the *Land Administration Act 1997* that local governments resolve to dedicate the road and it would be appreciated if Council could consider the matter at its next meeting and provide the following statement in a letter to Main Roads marked to my attention. This will satisfy the requirements of Regional and Metro Services (RMS) at the Department of Planning, Lands and Heritage who will be arranging the dedication of this land.

*"Council at its ordinary meeting held on (Day Month Year) passed a resolution for the dedication of the land being shown on Deposited Plans 405191, 406848 and Main Roads Land Dealing Plan 1060-089-1, as road pursuant to section 56 of the Land Administration Act 1997."*

In addition please provide a copy of the minutes of the Council meeting relating to the resolution for Department of Planning, Lands and Heritage records.

Main Roads will indemnify the Council against any costs and claims that may arise as a result of the dedication.

If you require any further information please contact me on 08 9323 4636.

Yours Sincerely

Alf Parolo  
Road Reserves Manager

VER.	AMENDMENT	AUTHORISED BY	DATE
3	REPLACEMENT PLAN- DoL INSTRUCTION, EXTENT/SUBJECT LOTS AMENDED	H.M. MARTIN	30.10.2015

LOT	FORMER PI/TENURE	ON PLAN/DIAGRAM	TITLE	TYPE	CROWN	S.S.A.	YES/NO
LOT 570 & ROAD WIDENING (LOT 601)	LOT 511	DP 67183	LR3159/287	PURPOSE	SUBDIVISION		
LOT 571	PT LOT 521	DP 74207	LR3163/537	PLAN OF			
ROAD WIDENING (LOT 600)	UCL						
ROAD WIDENING (LOT 602)	PT LOT 521 LOT 590	DP 74207 DP 72344	LR3163/537 LR3163/532				
ROAD WIDENING (LOT 603)	LOT 558	DP 407846					

LOTS 570-571 &  
ROAD WIDENINGS  
(LOTS 600-603)

FORMER TENURE  
SEE  
ABOVE  
TABLE  
D.O.L. FILE  
00337-2014.v01

LOCAL AUTHORITY  
CITY OF KARRATHA  
LOCALITY  
GAP RIDGE, NICKOL

FIELD RECORD 130245 (SAM 4998)

**SURVEYOR'S CERTIFICATE - REG 54**  
I, HANNAH M. MARTIN  
hereby certify that this plan is accurate and is a correct  
representation of the -  
(a) \*survey; and/or  
(b) \*calculations from measurements recorded in the field  
records,  
[\* delete if inapplicable]  
undertaken for the purposes of this plan and that it  
complies with the relevant written law(s) in relation to  
which it is lodged.  
2016.02.29  
11:05:57  
Hannah Martin  
LICENSED SURVEYOR +08'00' DATE

**LODGED**  
3-June-2015 \$0.00 17443203  
DATE FEE PAID ASSESS No.

I.S.C.

**EXAMINED**  
Barbara Francis  
Barbara Francis 10-March-2016 DATE

**WESTERN AUSTRALIAN PLANNING COMMISSION**  
FILE EXEMPT FROM WAPC APPROVAL

Delegated under S.16 P&D Act 2005 DATE

**IN ORDER FOR DEALINGS**  
SUBJECT TO  
- Prior Approval of DP407846  
- Reserve Action  
- Section 28(1) LAA - Auto Dedication

Barbara Francis 10-March-2016

FOR INSPECTOR OF PLANS AND SURVEYS DATE

**APPROVED**  
INSPECTOR OF PLANS AND SURVEYS DATE  
(S. 18 Licensed Surveyors Act 1909)



**DEPOSITED PLAN**  
**405191**  
SHEET 1 OF 4 SHEETS  
VERSION 3

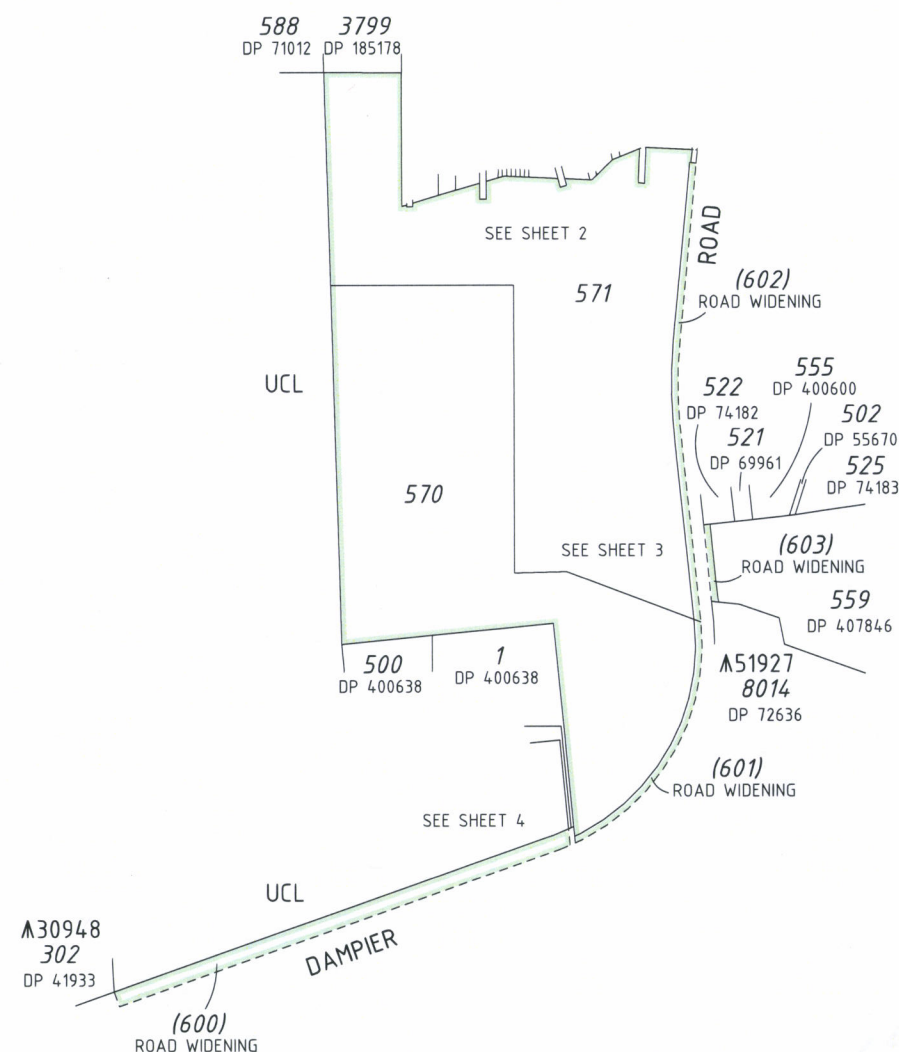

INTERESTS AND NOTIFICATIONS

SUBJECT	PURPOSE	STATUTORY REFERENCE	ORIGIN	LAND BURDENED	BENEFIT TO	COMMENTS
LOTS 600-603	NON-EXTINGUISHMENT OF NATIVE TITLE	SEC 24KA & 238 OF THE NATIVE TITLE ACT 1993		LOTS 600-603		



SCALE: 1:20000 AT A2 SIZE



S:\Projects\2017\777\04-Spatial\SD\201777dp4.dgn  
FP-20563-001-VER-2-0  
150311 hm final bdy.acs FP-201777-004-VER 1.0

HELD BY LANDGATE IN DIGITAL FORMAT ONLY

FOR HEADING SEE SHEET 1  
FOR INTERESTS AND NOTIFICATIONS SEE SHEET 1  
ALL DIMENSIONS SHOWN ON THIS SHEET ARE ORIGINAL

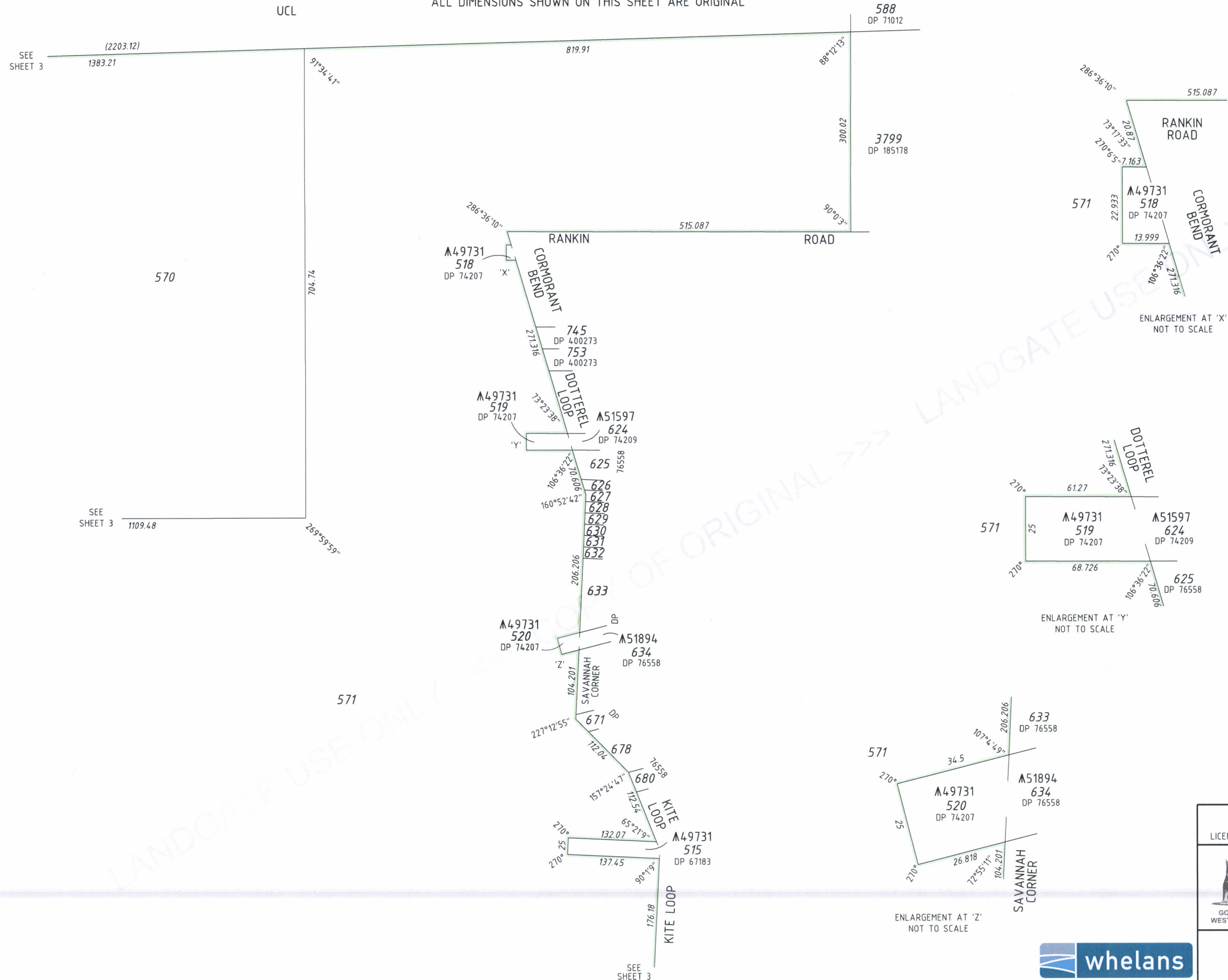

ENLARGEMENT AT 'X'  
NOT TO SCALE

ENLARGEMENT AT 'Y'  
NOT TO SCALE

ENLARGEMENT AT 'Z'  
NOT TO SCALE

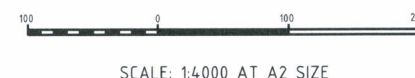

**whelans**  
WHELANS AUSTRALIA PTY. LTD.  
(08) 6241 3333 www.whelans.com.au  
S:\Projects\2017\7104-Spatial\SD\2017\7104\sh2\2.dgn  
FP-2017-004-VER 2.0

2016.02.29 11:06:17 +08'00'	
LICENSED SURVEYOR	DATE
DEPOSITED PLAN <b>405191</b> SHEET 2 OF 4 SHEETS VERSION 3	

UCL

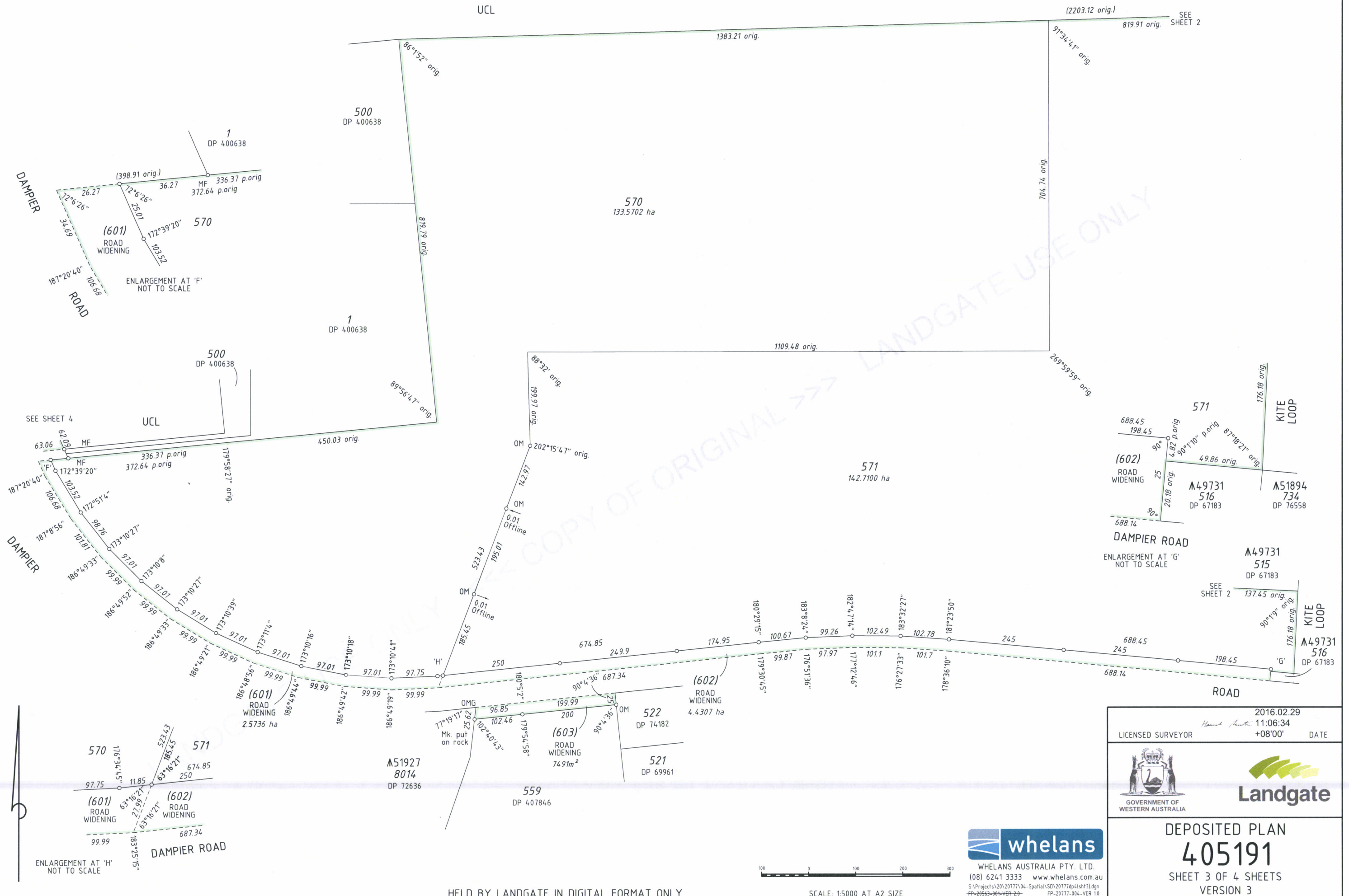

SCALE: 1:5000 AT A2 SIZE

 **whelans**  
WHELANS AUSTRALIA PTY. LTD.  
(08) 6241 3333 [www.whelans.com.au](http://www.whelans.com.au)  
S:\Projects\2017077104-Spatial\SD\2017077104\sh131.dgn  
FP-20563-001-VER 2.0 FP-20777-004-VER 1.0

2016.02.29	
<i>Harold Hunter</i>	11:06:34
LICENSED SURVEYOR	+08'00'
DATE	
	
GOVERNMENT OF WESTERN AUSTRALIA	Landgate

FOR HEADING SEE SHEET 1  
FOR INTERESTS AND NOTIFICATIONS SEE SHEET 1

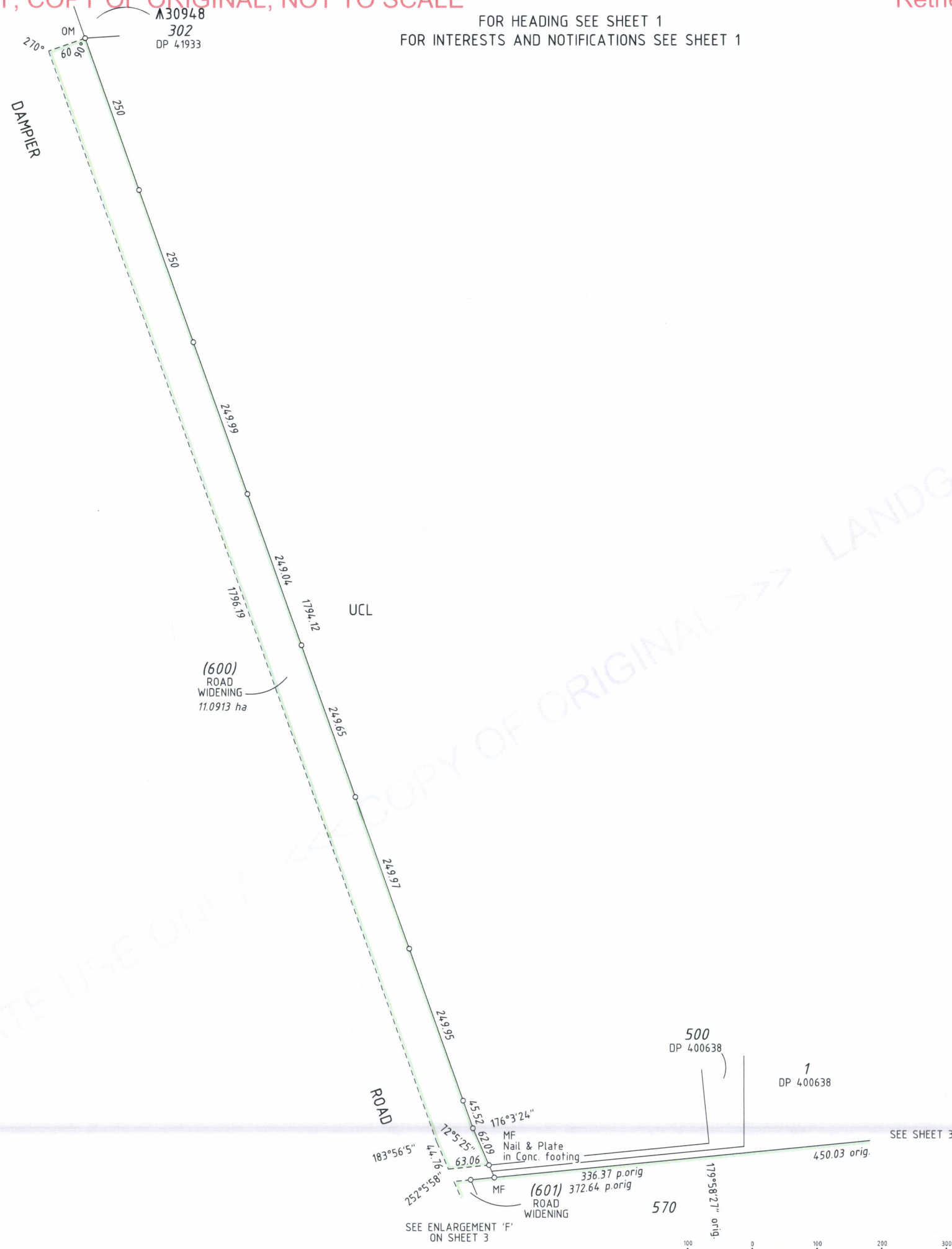

2016.02.29	
LICENSED SURVEYOR	DATE
 	
DEPOSITED PLAN	
405191	
SHEET 4 OF 4 SHEETS	
VERSION 3	

**whelans**  
WHELANS AUSTRALIA PTY. LTD.  
(08) 6241 3333 www.whelans.com.au  
S:\Projects\20\20777\04-Spatial\SD\20777dp4\shf4.dgn  
FP-20563-001-VER 2.0 FP-20777-004-VER 1.0

COMPILED FROM DP'S 40583, 64662, 67837, 67838, 74707 & 242988

LOT	FORMER PI/TENURE	ON PLAN/DIAGRAM	TITLE	TYPE	CROWN	S.S.A.	YES/NO
LOTS 550-557	UCL			PURPOSE	SUBDIVISION		
LOT 558	LOT 572	DP 67837	LR 3024/243	PLAN OF			
LOT 559	LOT 579	DP 67837	LR 3024/244				
LOT 560	LOT 580	DP 67837	LR 3024/245				

## ROAD WIDENINGS (LOTS 550-560)

FORMER TENURE D.O.L. FILE  
SEE TABLE 00336-2024

LOCAL AUTHORITY  
CITY OF KARRATHA  
LOCALITY  
STOVE HILL

FIELD RECORD  
COMPILED

### SURVEYOR'S CERTIFICATE - Compiled

I, PAUL C.C. RHODES  
hereby certify that this compiled plan -  
(a) is a correct and accurate  
representation of the survey(s)  
of the subject land; and  
(b) is in accordance with the relevant  
law in relation to which it is  
lodged.

Paul Charles Cecil Rhodes  
2015.12.07 15:21:26 +08'00'  
LICENSED SURVEYOR DATE

LODGED  
9-Dec-2015 \$0.00 18565847  
DATE FEE PAID ASSESS No.

I.S.C.

EXAMINED  
J SEAGAR 5-JAN-2016  
DATE

WESTERN AUSTRALIAN PLANNING COMMISSION  
FILE EXEMPT FROM WAPC APPROVAL

Delegated under S.16 P&D Act 2005 DATE

IN ORDER FOR DEALINGS  
SUBJECT TO

DEDICATION ACTION  
5-JAN-2016  
DATE

FOR INSPECTOR OF PLANS AND SURVEYS

APPROVED  
INSPECTOR OF PLANS AND SURVEYS  
(S. 18 Licensed Surveyors Act 1909) DATE

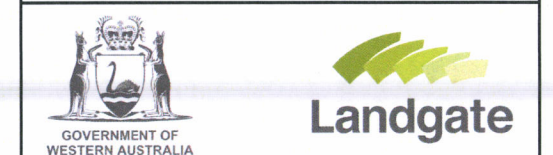

DEPOSITED PLAN  
406848

SHEET 1 OF 2 SHEETS - VERSION 1

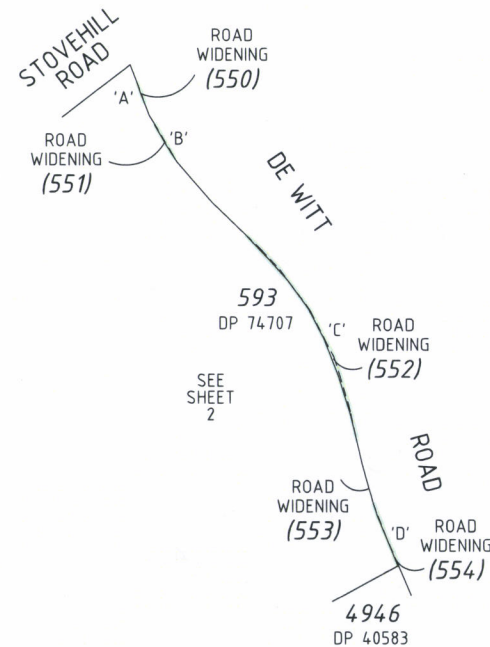

SUBJECT TO SURVEY  
NOT FOR ALIENATION PURPOSES

FOR ENLARGEMENTS 'A' TO 'H' & 'J'  
SEE SHEET 2

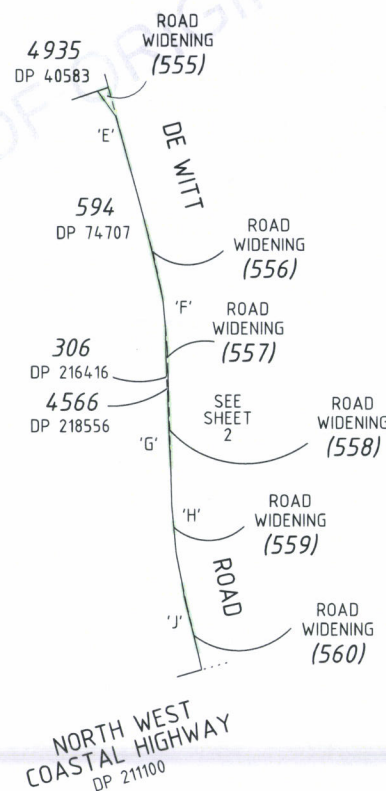

### INTERESTS AND NOTIFICATIONS

SUBJECT	PURPOSE	STATUTORY REFERENCE	ORIGIN	LAND BURDENED	BENEFIT TO	COMMENTS
ALL LOTS	NON-EXTINGUISHMENT OF NATIVE TITLE	SEC 24KA & 238 NATIVE TITLE ACT 1993		ALL LOTS		



SCALE: 1:15000 AT A2 SIZE



HELD BY LANDGATE IN DIGITAL FORMAT ONLY

FOR HEADING SEE SHEET 1



 Paul Charles Cecil Rhodes 2015.12.07 15:21:58 +08'00' LICENSED SURVEYOR		DATE
 GOVERNMENT OF WESTERN AUSTRALIA		
DEPOSITED PLAN <b>406848</b>		
SHEET 2 OF 2 SHEETS - VERSION 1		

**whelans**  
 WHELANS AUSTRALIA PTY. LTD.  
 (08) 6241 3333 www.whelans.com.au  
20790dp1\sh21.dgn  
 FP-20790-001-VER 1.0

N	DESCRIPTION	VERIFIED	DATE	MICRO DATE
1.	TRUNCATION DIMENSION AMENDED	<i>[Signature]</i>	16/11/10	

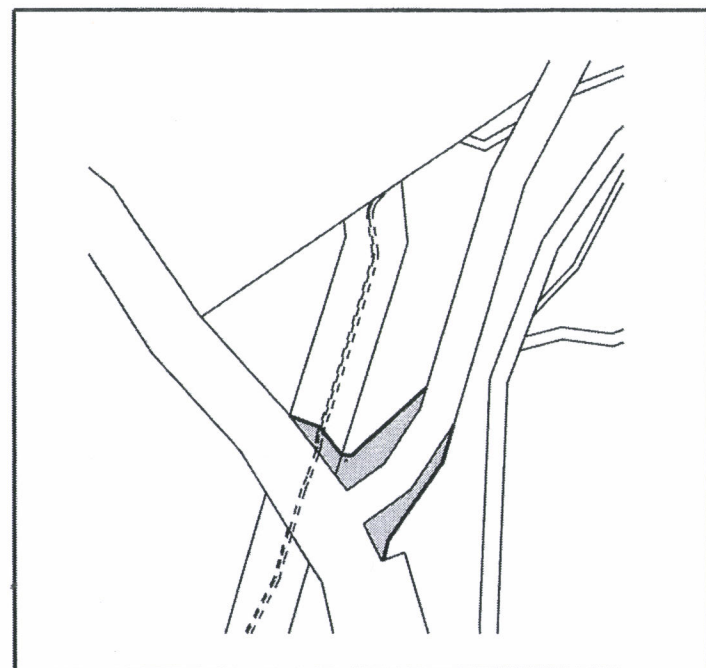

LOCATION PLAN

LOT 451  
C/T: LR3115/863  
OWNER: STATE OF W.A.  
EASEMENT: K644320  
AREA REQUIRED = 6900 m<sup>2</sup>

LOT 444  
C/T: LR3115/831  
OWNER: STATE OF W.A.  
AREA REQUIRED = 5694 m<sup>2</sup>

C A 36991  
C/T: LR3110/518  
PRIMARY INTEREST HOLDER: WATER CORPORATION  
PURPOSE: WATER SUPPLY & PIPELINE  
MANAGEMENT ORDER: H114362  
EASEMENT: K644320  
AREA REQUIRED = 2549 m<sup>2</sup>

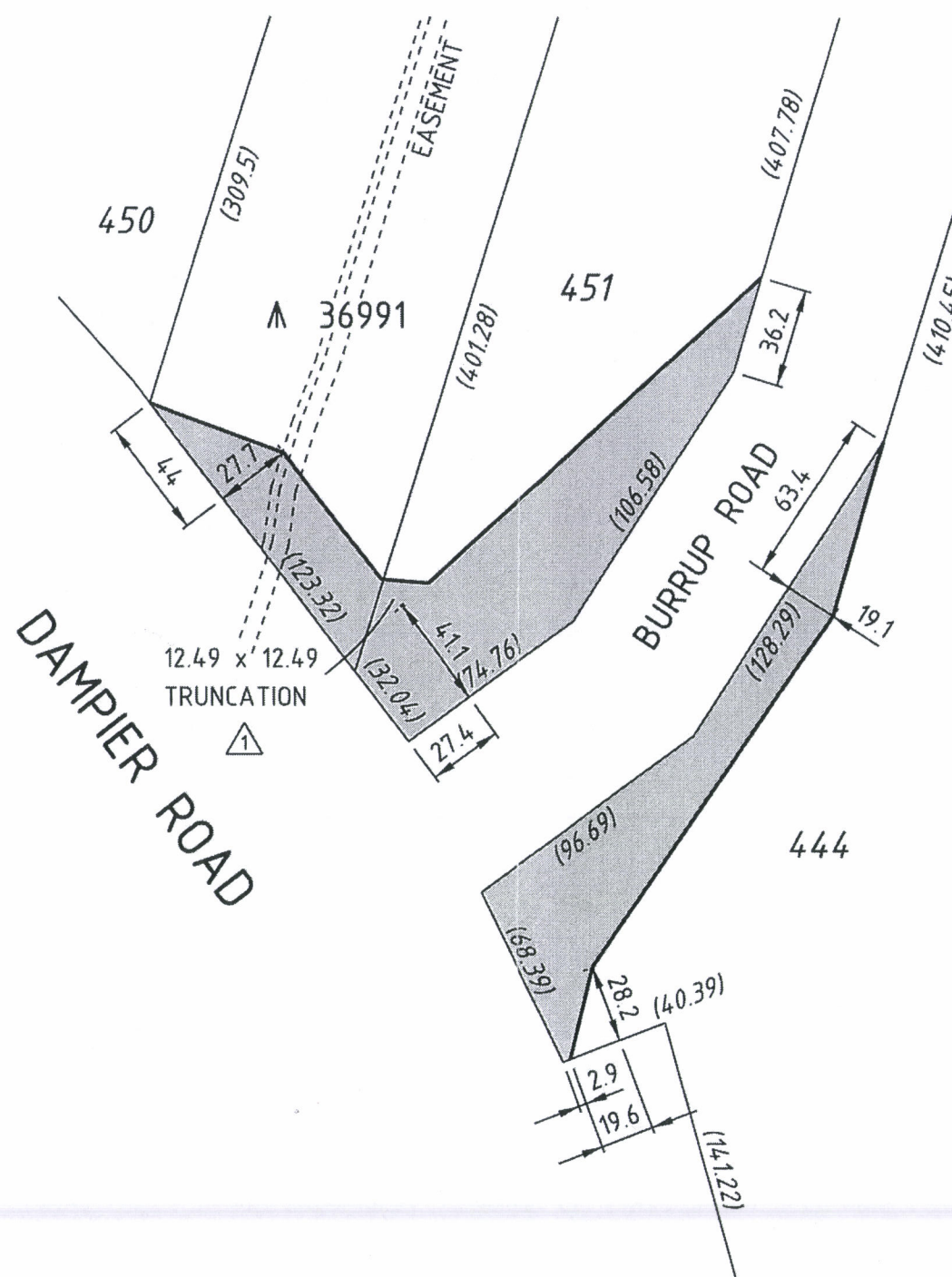

## LEGEND

- LAND REQUIRED FOR ROAD PURPOSES
- BOUNDARY TO BE SURVEYED.

## NOTES

- DIMENSIONS AND AREAS ARE APPROXIMATE ONLY AND ARE SUBJECT TO SURVEY.
- S.L.K. IS A M.R. STRAIGHT LINE KILOMETRE AND IS APPROXIMATE ONLY
- HORIZONTAL DATUM IS KAR94 PROJECT GRID

## INFRASTRUCTURE DELIVERY DIRECTORATE

Telephone 9323 4636 Fax 9323 4930

### APPROVED FOR IMPLEMENTATION

FILE NUMBER	FOLIO	DATE	APPROVAL NUMBER
09/547			
AUTHORISED	A. PAROLO		19/10/10
APPROVED	K. KUGANANTHAN		19/10/10



### FINANCE AND SERVICES PROPERTY MANAGEMENT

Telephone 9323 4580 Fax 9323 4600

FILE No. 10/6304

DRAWN/DESIGNED W.M. ROLLINGS 14/10/10

AUDITED IN ACCORDANCE WITH STANDARD 67-98-48 IN THE ROAD AND TRAFFIC ENGINEERING MANUAL

## DAMPIER RD H46

### LAND DEALINGS

LOTS 444, 451 & A 36991, 24.24 S.L.K.

LOCAL AUTHORITY (814) SHIRE OF ROEBOURNE

DRAWING TYPE	DRAWING NUMBER	AMEND.
7200	1060-086-1	

THIS DRAWING IS AN AMENDMENT OF THE APPROVED DRAWING. *[Signature]* 16/12/10

300  
200  
100  
0  
1:2500  
SCALE  
21/10/10  
SCAN DATE  
A  
3